



Bilton Church of England Junior School

Plantagenet Drive, Rugby CV22 6LB Tel 01788 810675

Head of School – Mrs R Ross

Assistant Head of School – Mrs A Thompson

Assistant Head of School - Miss A Lewis

There are no outsiders @ BJS - everyone is welcome

office@biltonjuniorschool.co.uk

www.biltonjuniorschool.co.uk

How to set up Gmail and Google Classroom.

What is Google Classroom?

Google Classroom is a classroom-management tool integrated into Google's G Suite for Education, which Google provides free to schools. Classroom allows students to see what's due, complete assignments, post messages, and more in virtual classes set up by their teachers. The fact that it's paperless and offers built-in opportunities for children to practice responsible digital skills are great bonuses. In fact, tens of millions of teachers and students use Google Classroom in thousands of schools around the world, making it one of the most popular digital teaching tools around.

However, even though Google Classroom is an excellent digital learning platform it does come with some risks, like with all digital platforms, including data tracking, potential contact with strangers, and even cyberbullying. While Google has stricter privacy practices for its educational apps, it can collect student data from some of the Classroom tools, such as YouTube, if they're enabled. However, Bilton Junior School have added more security procedure around children using this platform. The administrator is notified of any words/language used that would be cause for concern. Children can only email within the domain of Bilton Junior School. Google pitches the platform to teachers as "mission control for your classroom" -- and it streamlines homework, post messages, attach letters, remote learning, and is an invaluable tool to keep in contact with the children. But as more schools move toward using Google Classroom, it's a good idea to familiarise yourself with its capabilities so you can best support your child's online learning. There are loads of You Tube videos about Google Classroom.

We ask that all parents monitor their child in the use of Google Classroom.

Setting up Gmail:

Your child will bring home their log in details in the next couple of weeks when they have had an opportunity to log on to their accounts in school. Please can you help them set up a Gmail account and access Google Classroom from your home computer. Here are the following steps.

From Google search engine type in google mail.

You will get a sign in screen -enter your child's email address: (usually first name initial and surname@biltonjuniorschool.co.uk)

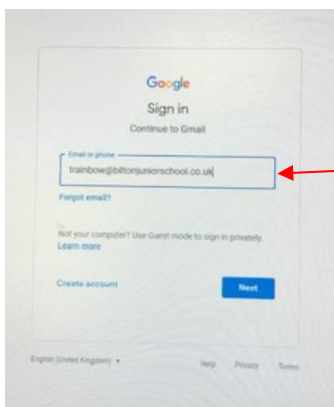

Enter the child's email address which you have been sent

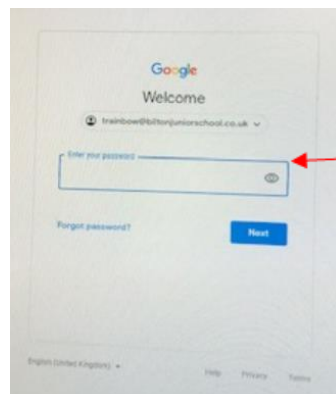

The Password is your child's class teachers name and a number (note capital letters with no space)

Once these steps are done you are into your child's Gmail account:

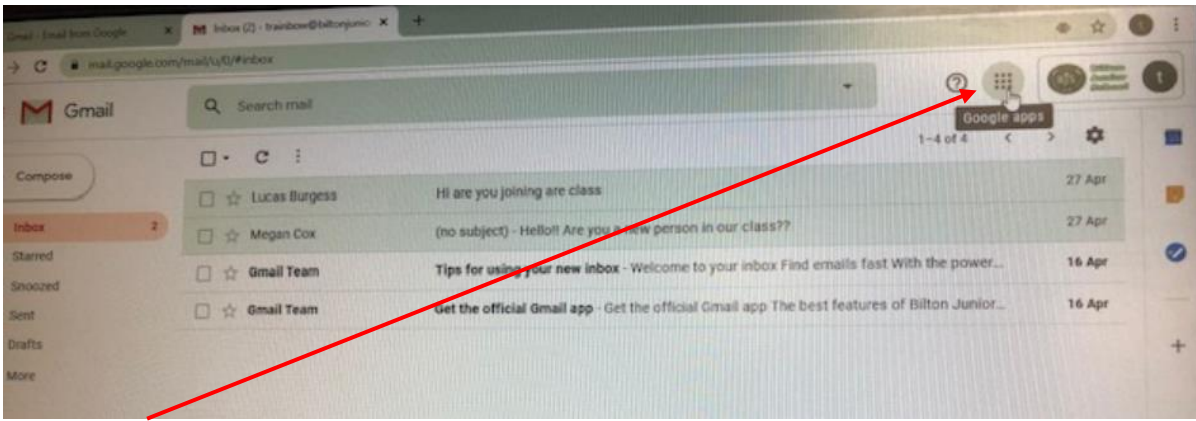

Then go to the 3x3 dots (as shown) and click. You will see Google Classroom icon click on this.

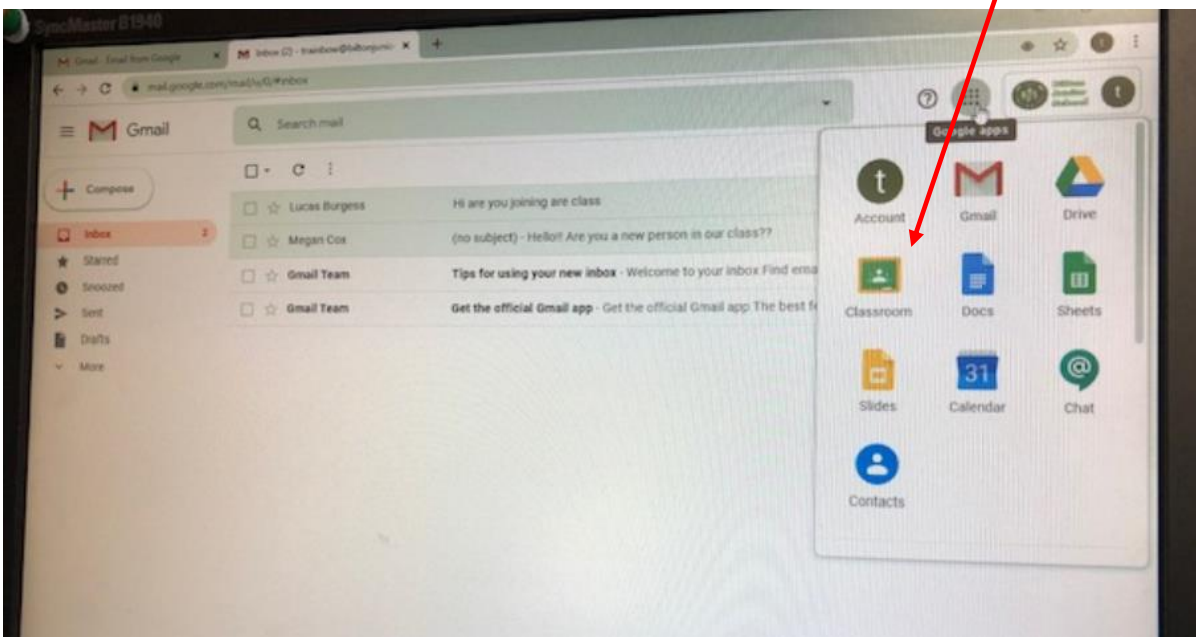

You are then in Google Classroom –

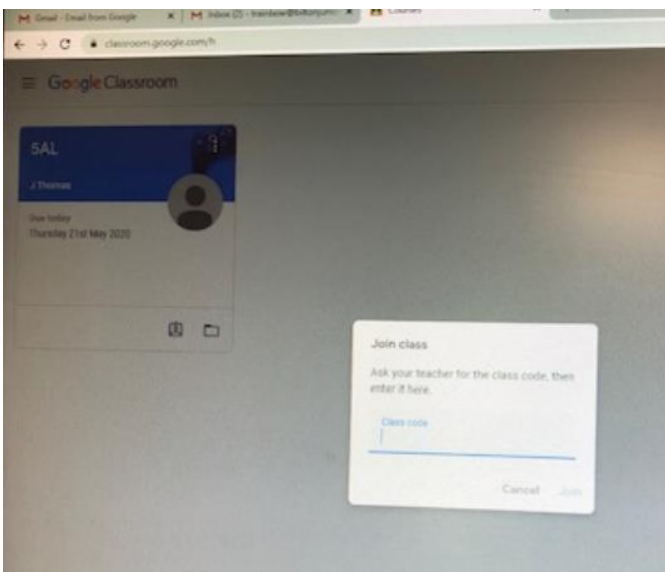

Join the class. You are now set up in Google Classroom and will be able to see teachers' posts and homework assignments.



International Cross of Nails Schools